

**KOINE'**  
design Mandalaki



**LUCE  
PLAN**

A07/8D A07/9D



A07/8D

A07/9D

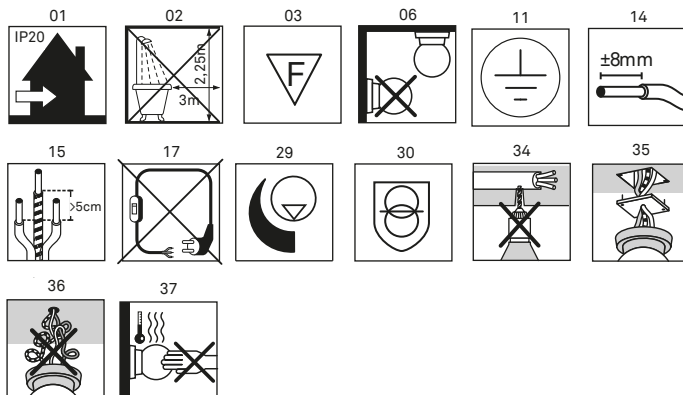

A07/8D

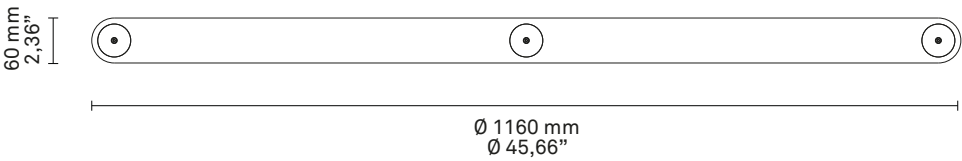
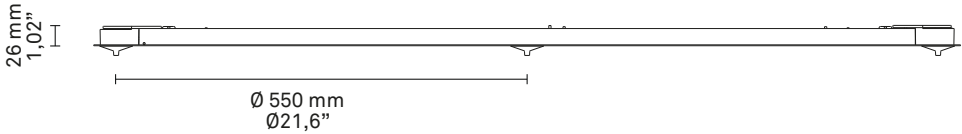
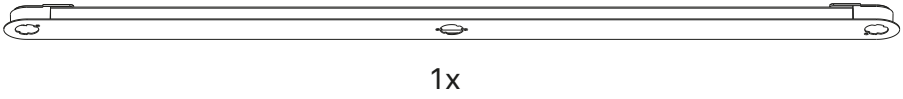

**kg** ??kg

**lb** ??lbs

A07/8D

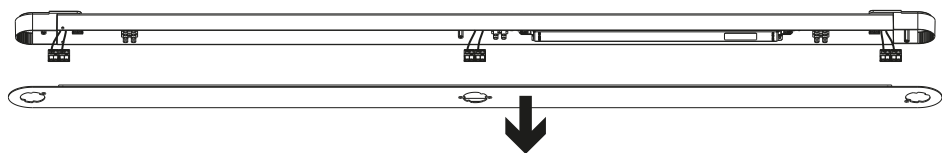
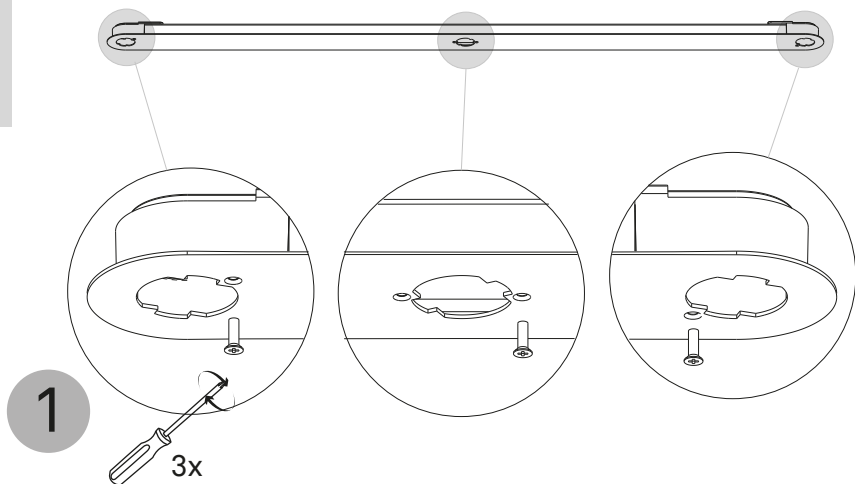
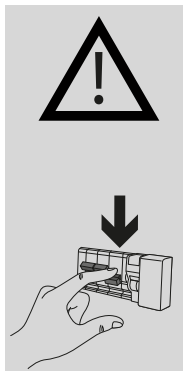

1a

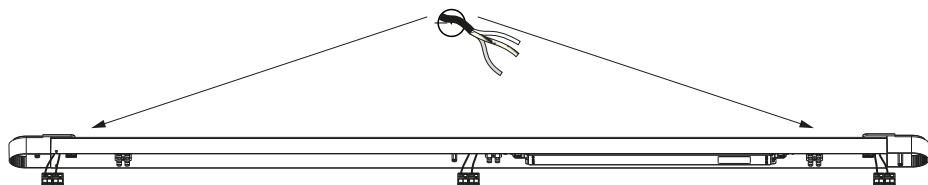

2

70 mm  
2,75"

2a

70 mm  
2,75"

1100 mm  
43,3"

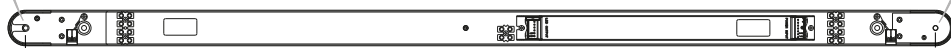

2b



A07/8D

3

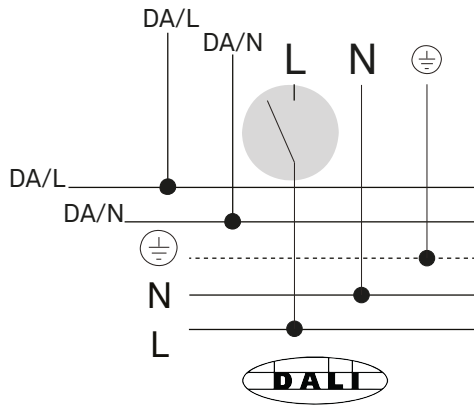
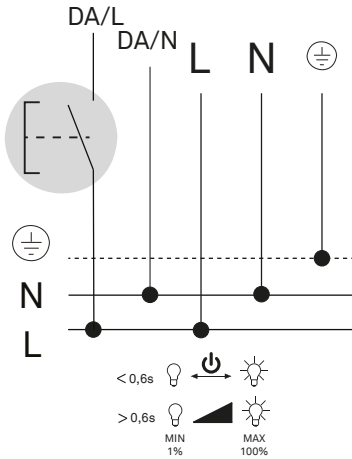
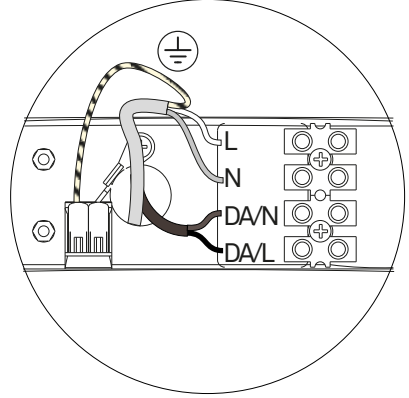
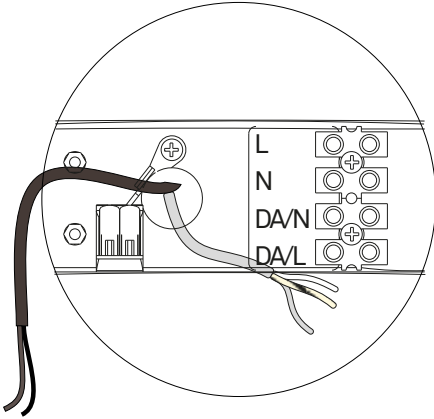
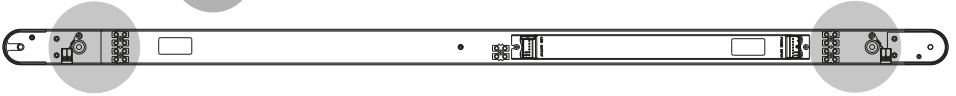

A07/8D + A07S20

4

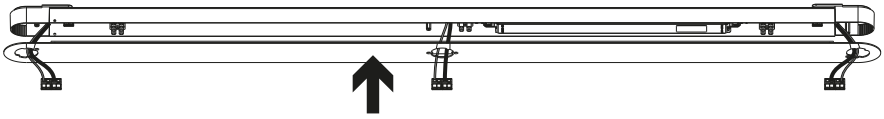

4a

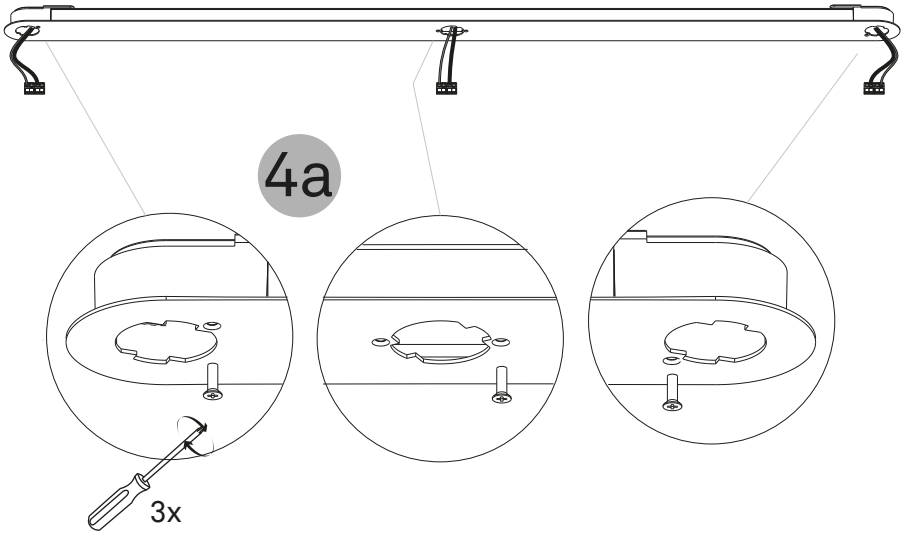

A07/8D + A07S20

3x 

I<sub>out</sub>: max 350mA<sub>dc</sub>  
 V<sub>out</sub>: max 35 V<sub>dc</sub>  
 SELV

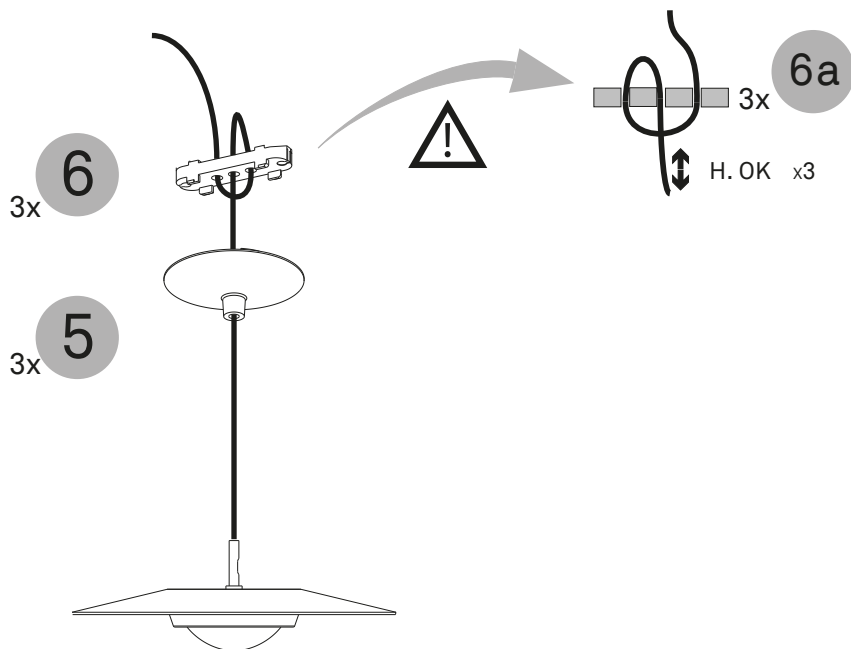
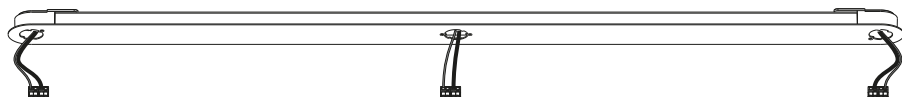



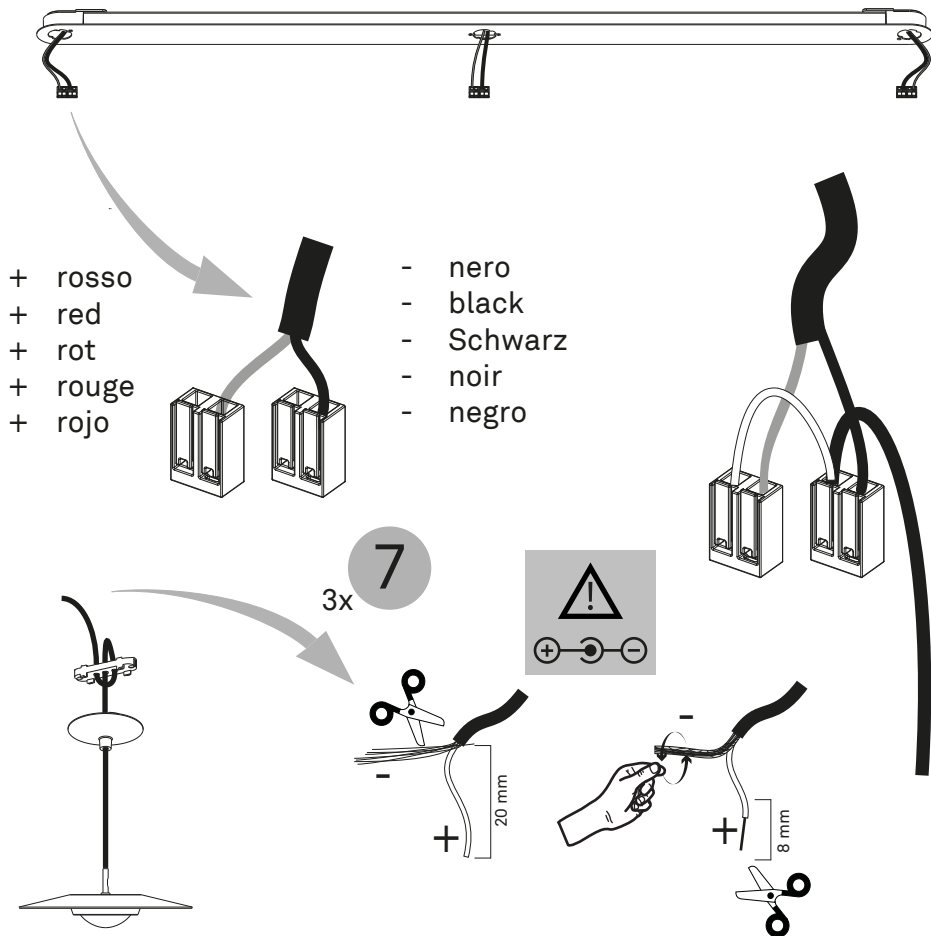

+ rosso  
+ red  
+ rot  
+ rouge  
+ rojo

- nero  
- black  
- Schwarz  
- noir  
- negro

7  
3x



20 mm

8 mm

polo positivo  
positive pole  
Pluspol pole  
pôle positif  
terminal positivo

conduttore con guaina interno  
inner sheathed conductor  
Leiter mit innerer Umhüllung  
conducteur avec gaine intérieure  
conductor con vaina interior

polo negativo  
negative pole  
Minus pole  
pôle négatif  
terminal negativo

rivestimento esterno  
outer jacket  
Außenbeschichtung  
revêtement extérieur  
revestimiento exterior

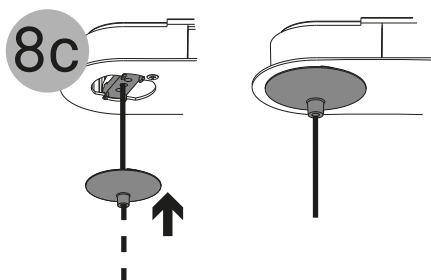
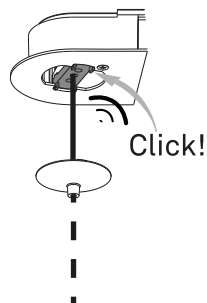
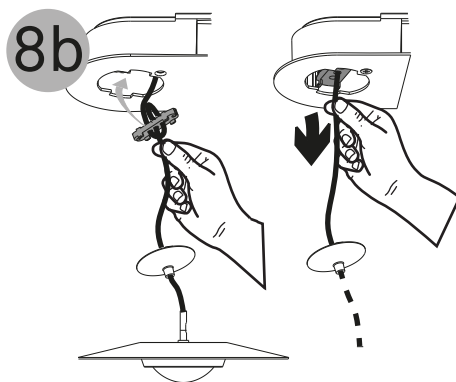
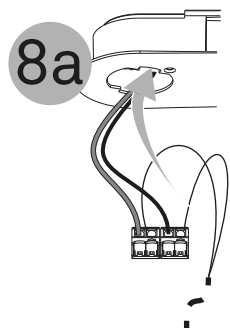
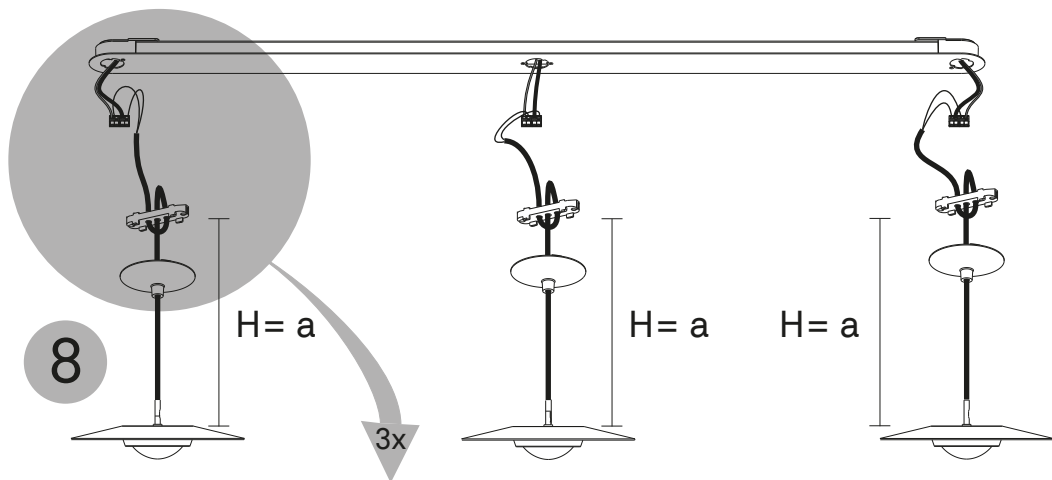

A07/9D+A07/8D

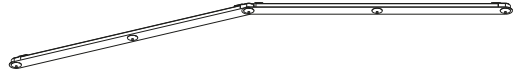

A07/9D



A07/8D + A07/9D

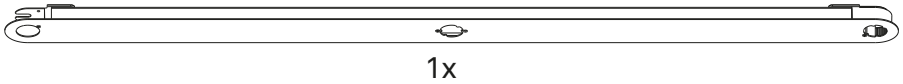

2x



2x



26 mm  
1,02"

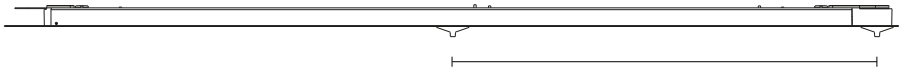

Ø 550 mm  
Ø 21,6"

60 mm  
2,36"



Ø 1160 mm  
Ø 45,66"

**kg** ??kg

**lb** ??lbs

A07/9D+A07/8D

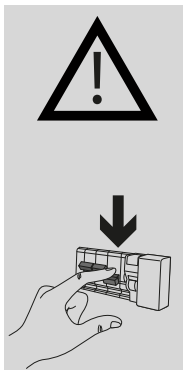

A07/8D  
1 + 2 + 3

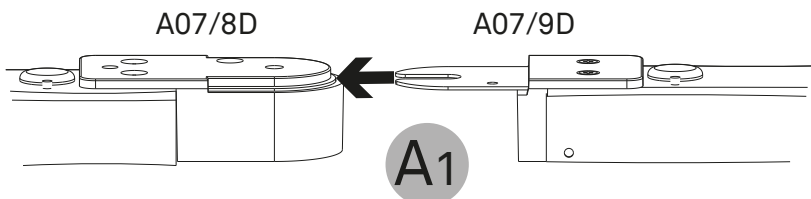
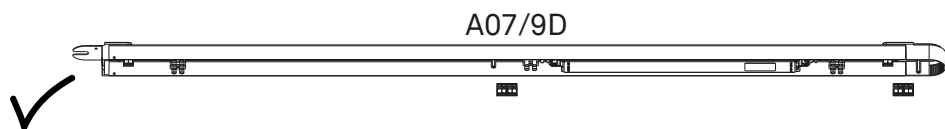
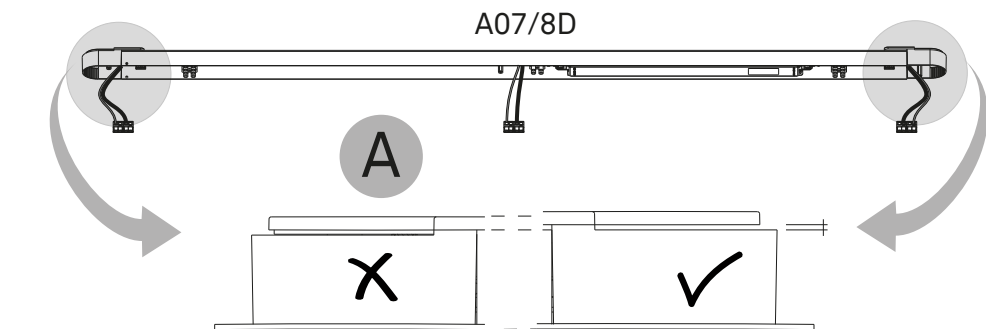

A07/9D+A07/8D

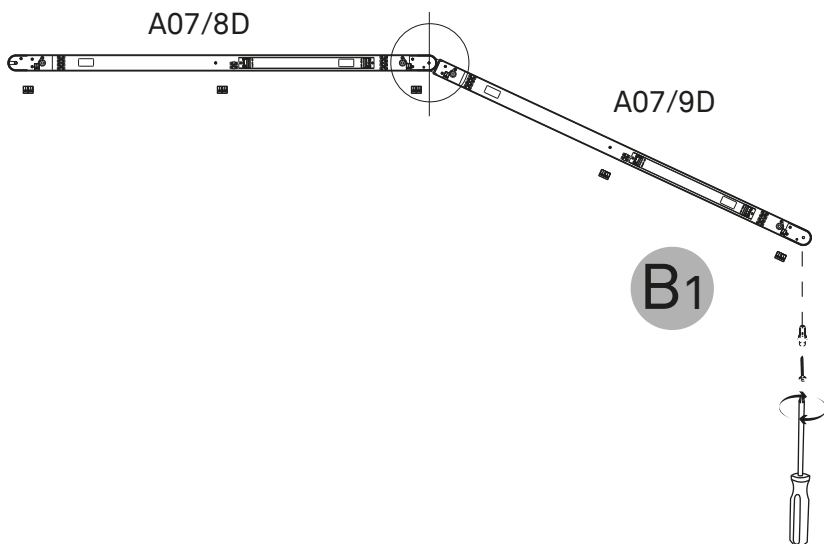
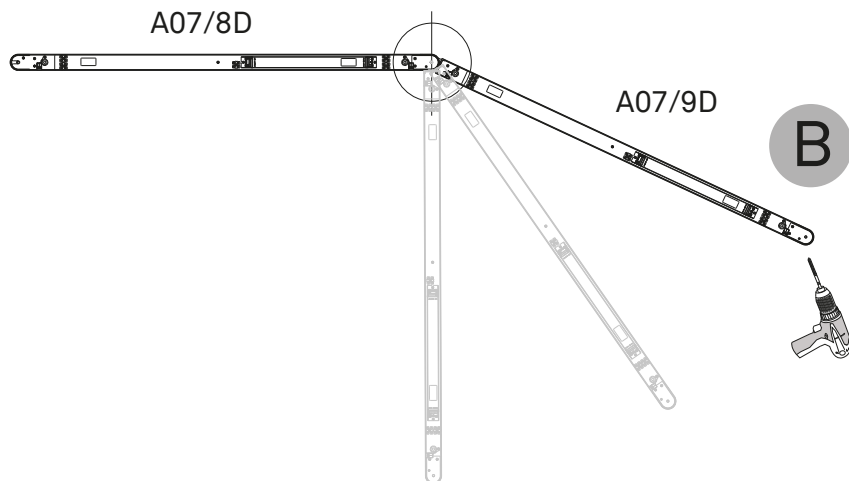

A07/9D+A07/8D

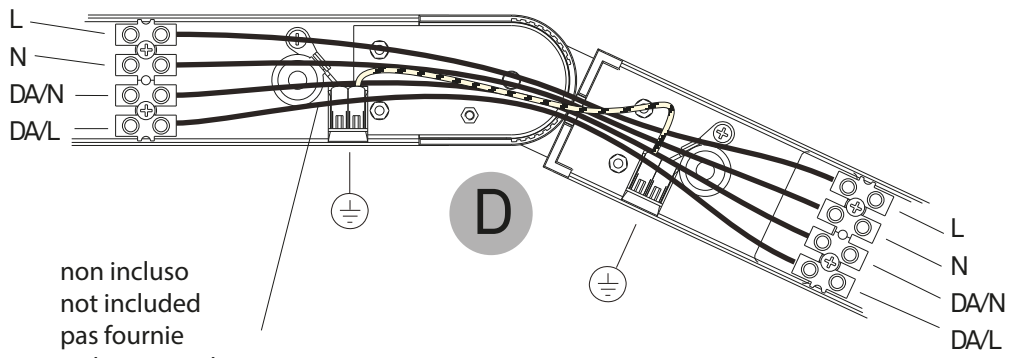
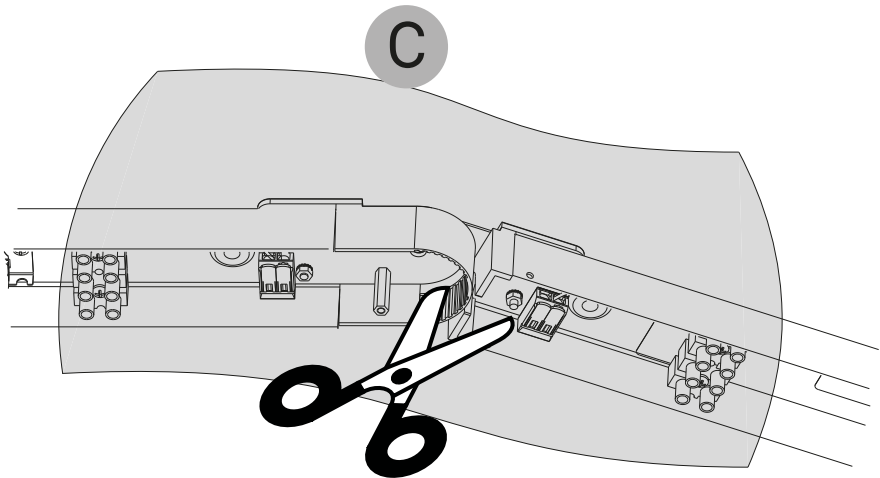
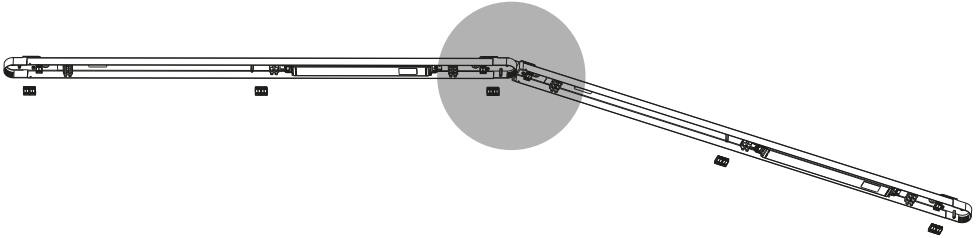

non incluso  
not included  
pas fournie  
nicht vorgesehen  
no provisto

A07/9D+A07/8D+A07S20

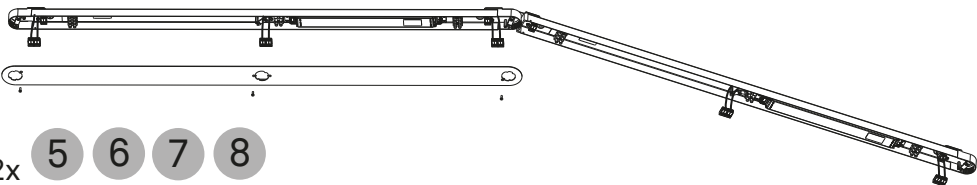

2x 5 6 7 8

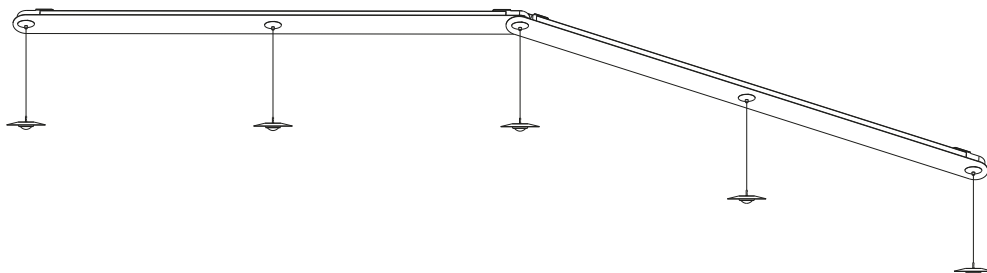
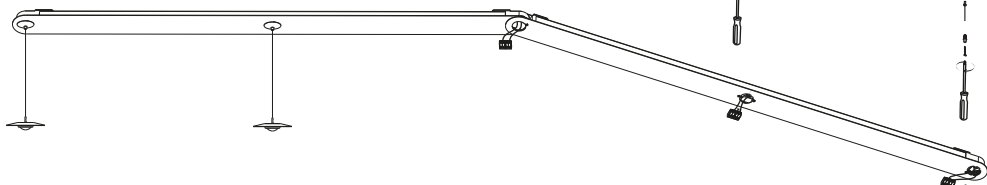
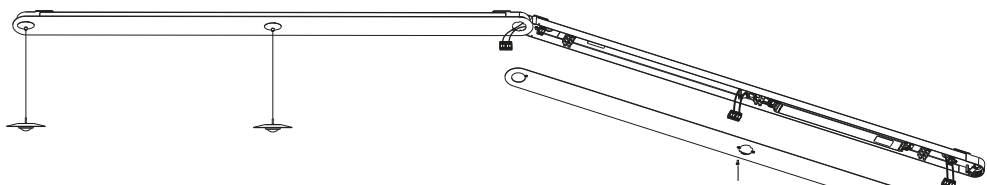
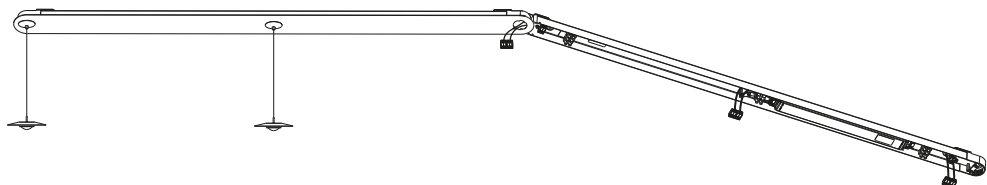

A07S20  
A07S37  
A07S55

A07S11

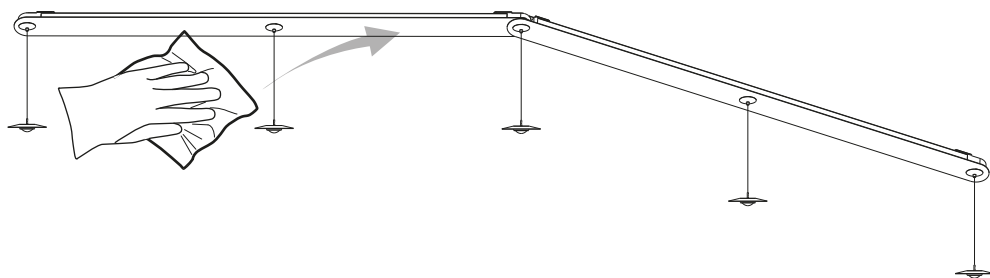
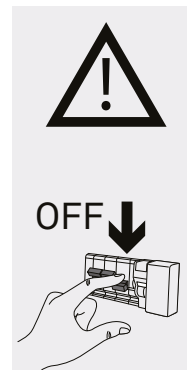
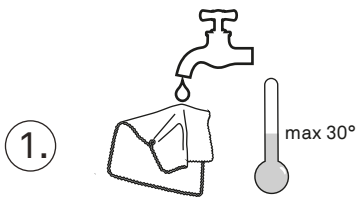







ECODESIGN  
 SYMBOL LEGEND  
 LEGENDA DEI SIMBOLI  
 ERLAEUTERUNG DER SYMBOLE  
 LEGENDE DES SYMBOLES  
 LEYENDA DE LOS SIMBOLOS

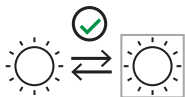

Replaceable light source by end-user  
 Fonte luminosa sostituibile dal cliente finale  
 Austauschbare Lichtquelle durch den Endanwender  
 Source lumineuse remplaçable par l'utilisateur final  
 Fuente de luz reemplazable por el usuario final

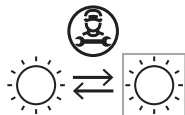

Replaceable light source by a professional  
 Fonte luminosa sostituibile da un professionista  
 Austauschbare Lichtquelle durch einen Fachmann  
 Source lumineuse remplaçable par un professionnel  
 Fuente de luz reemplazable por un profesional



Replaceable (LED only) light source by end-user  
 Fonte luminosa (solo LED) sostituibile dal cliente finale  
 Austauschbare (nur LED) Lichtquelle durch den Endanwender  
 Source lumineuse remplaçable (LED uniquement) par l'utilisateur final  
 Fuente de luz reemplazable (sólo LED) por el usuario final

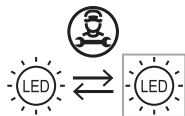

Replaceable (LED only) light source by a professional  
 Fonte luminosa (solo LED) sostituibile da un professionista  
 Austauschbare (nur LED) Lichtquelle durch einen Fachmann  
 Source lumineuse remplaçable (LED uniquement) par un professionnel  
 Fuente de luz reemplazable (sólo LED) por un profesional



Non-replaceable light source  
 Fonte luminosa non sostituibile  
 Nicht austauschbare Lichtquelle  
 Source lumineuse non remplaçable  
 Fuente de luz no reemplazable

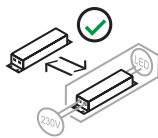

Replaceable control gear by an end-user  
 Unità di alimentazione sostituibile dal cliente finale  
 Austauschbares Vorschaltgerät durch einen Endanwender  
 Pièce d'alimentation remplaçable par l'utilisateur final  
 Unidad de alimentación reemplazable por el usuario final

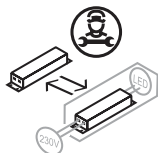

Replaceable control gear by a professional  
 Unità di alimentazione sostituibile da un professionista  
 Austauschbares Vorschaltgerät durch einen Fachmann  
 Pièce d'alimentation remplaçable par un professionnel  
 Unidad de alimentación reemplazable por un profesional

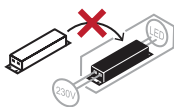

Non-replaceable control gear  
 Unità di alimentazione non sostituibile  
 Nicht austauschbares Vorschaltgerät  
 Pièce d'alimentation non remplaçable  
 Unidad de alimentación no reemplazable





[www.luceplan.com](http://www.luceplan.com)

A07010005